



3 Bed
House - Semi-
Detached
located in Belford

£750 Per Calendar Month



HOTSPUR
RESIDENTIAL

DIRECTIONS

CONTACT

Hotspur Residential Market Place
Alnwick
Northumberland
NE66 1HS

E: info@hotspurresidential.co.uk
T: 01665 602626
www.hotspurresidential.co.uk



HOTSPUR
RESIDENTIAL

Ground Floor

Approx. 36.9 sq. metres (397.6 sq. feet)

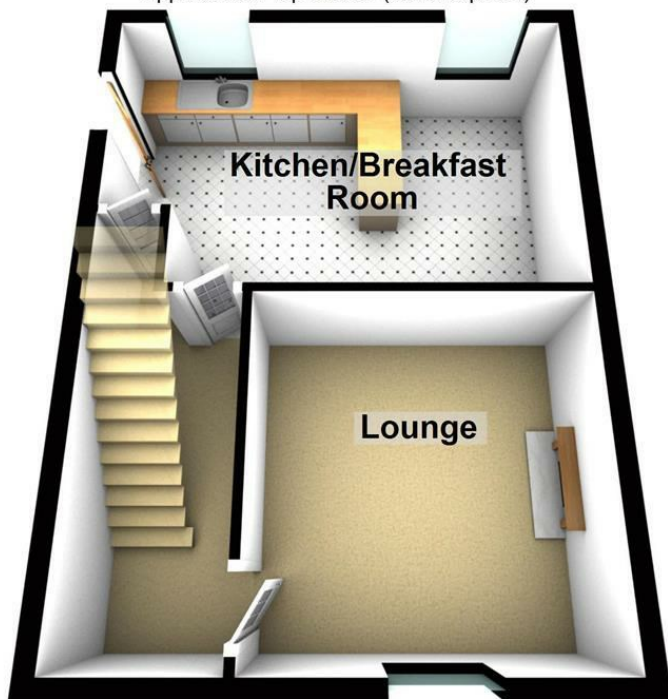

First Floor

Approx. 36.9 sq. metres (397.6 sq. feet)

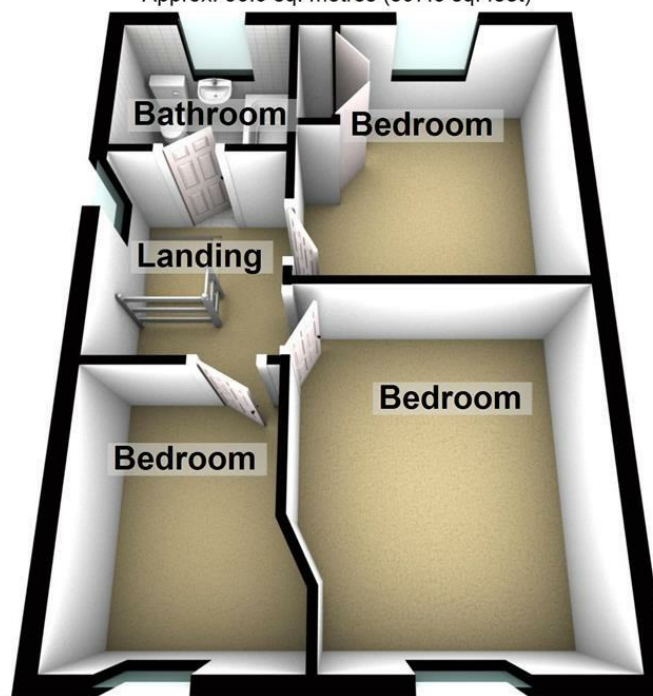

Total area: approx. 73.9 sq. metres (795.3 sq. feet)

Floor plan is approximate and is provided for visual reference only.
Plan produced using PlanUp.

Dinningside

| Energy Efficiency Rating | | |
|---|---------|-----------|
| | Current | Potential |
| Very energy efficient - lower running costs | | |
| (92 plus) A | | |
| (81-91) B | | 85 |
| (69-80) C | | |
| (55-68) D | 63 | |
| (39-54) E | | |
| (21-38) F | | |
| (1-20) G | | |
| Not energy efficient - higher running costs | | |
| EU Directive 2002/91/EC | | |
| England & Wales | | |